

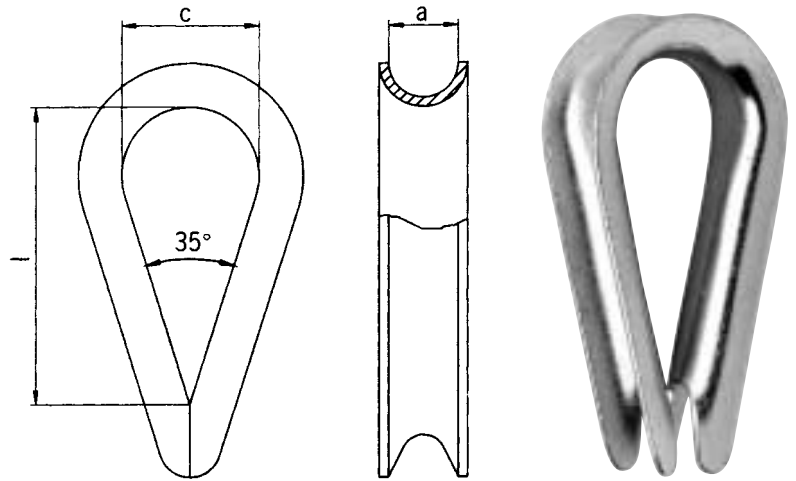

DIN 65457
(voorheen A-Din 6899)

Kousen
Kauschen
Thimbles
Cosses

Verzinkt/verzinkt/galvanized/zingué



 Art.no.	a mm	l mm	c mm	Gewicht Gewicht Weight Poids kg/100	St./Pcs.
700-03E	4	23,5	11	0,35	100
700-04E	5	28,5	13	0,42	100
700-05E	6	30	14	0,80	100
700-06E	7	33	15	0,81	100
700-08E	9	39	18	1,70	100
700-10E	11	47,5	22	3,50	50
700-12E	13	56,5	26	5,25	25
700-13E	14	61	28	7,25	25
700-15E	16	69,5	32	7,85	20
700-16E	18	78	35	17,90	
700-18E	20	86,5	40	27,00	
700-20E	22	95	44	35,50	
700-22E	24	97	46	38,80	
700-24E	26	100	48	52,00	

09.2005

Zonder aansprakelijkheid / Unverbindlich / Without warranty / Sans engagement

06.01

B-DIN 6899

Kousen
Kauschen
Thimbles
Cosses

Verzinkt/verzinkt/galvanized/zingué

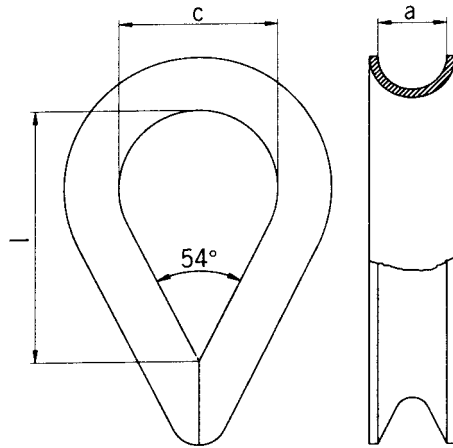



 Art.no.	a	l	c	s	Gewicht Gewicht Weight Poids kg/100	St./Pcs.
	mm	mm	mm	mm		
710-02E	3	19	11	1,3	0,5	100
710-03E	4	21	13	1,6	0,8	100
710-04E	5	23	14	1,9	1,0	100
710-05E	6	25	16	2,4	1,6	100
710-06E	7	28	18	2,4	1,9	100
710-07E	8	32	20	2,8	3,0	100
710-09E	10	38	24	3,1	4,7	50
710-11E	12	45	28	3,3	6,8	50
710-13E	14	51	32	3,7	10,0	25
710-15E	16	58	36	3,8	14,5	
710-18E	20	72	45	5,7	29,0	
710-20E	22	80	50	5,7	32,0	
710-22E	24	90	56	6,5	47,0	
710-24E	26	99	62	6,8	59,0	
710-26E	28	112	70	8,0	80,0	
710-28E	30	120	75	8,0	110,0	
710-30E	32	128	80	8,0	123,0	

09.2005

DIN 689

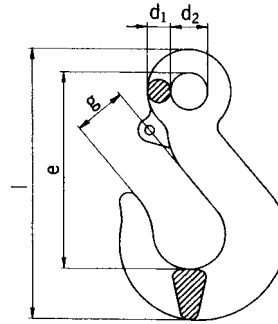
Lasthaken met oog
Ösenhaken
Hooks with eye
Crochets avec œil
 Blank/blank/polished/poli



 Art.no.	d2	e	g	WLL	Gewicht	St./Pcs.
	mm	mm	mm	kg	Gewicht Weight Poids kg/100	
689-02B	9,5	62	18	250	15	
689-05B	12,5	82	24	500	35	
689-10B	17	113	33	1000	80	
689-16B	20,5	133	39	1600	140	
689-25B	25,5	167	49	2500	285	
689-40B	32	211	62	4000	580	
689-50B	36	236	69	5000	800	

6

Lasthaken met oog
Ösenhaken
Hooks with eye
Crochets avec œil
 Alloy staal, gelakt
 Alloy stahl, lackiert
 Alloy steel, painted
 Acier alli , laqu 

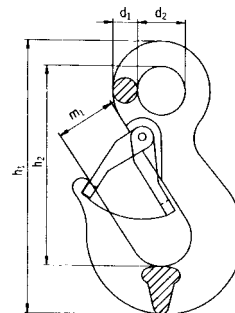



 Art.no.	h2	d2	m1	WLL	Gewicht	St./Pcs.
	mm	mm	mm	kg	Gewicht Weight Poids kg/100	
691-10KL	81	19	24	1000	25	
691-15KL	93	23	26	1500	40	
691-20KL	104	28	27	2000	61	
691-32KL	119	31	31	3200	90	
691-45KL	146	39	38	4500	184	

09.2005

Lasthaken met gaffel
Gabelkopfhaken
Clevis sliphooks
Crochets avec chape

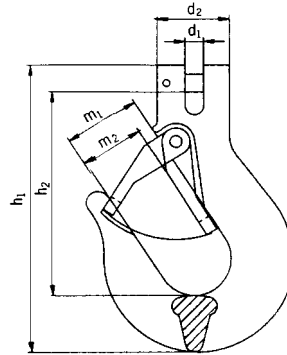
Alloy staal, gelakt
 Alloy stahl, lackiert
 Alloy steel, painted
 Acier allié, laqué



 Art.no.	h2	d1	m2	WLL	Gewicht Gewicht Weight Poids kg/100	St./Pcs.
	mm	mm	mm	kg		
692-20KL	95	9	25	2000	70	
692-32KL	125	11	38	3200	130	
692-50KL	155	14	46	5000	250	

6

TYPE 580

Oogbouten
Ringschrauben
Eye-bolts
Anneaux de levage, mâle

E = Verzinkt/verzinkt/galvanized/zingué
 B = Blank/blank/polished/poli

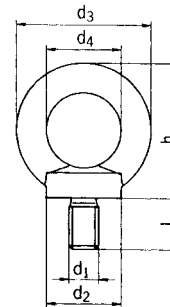

 Art.no.	d1	d3	d4	l	h	WLL		Gewicht Gewicht Weight Poids kg/100	St./Pcs.
	mm	mm	mm	mm	mm	kg	kg		
580-06	M 6	36	20	13	31	-	-	3	25
580-08	M 8	36	20	13	36	140	95	6	25
580-10	M 10	45	25	17	45	230	170	11	25
580-12	M 12	54	30	20,5	53	340	240	18	25
580-14	M 14	63	35	27	62	-	-	23	10
580-16	M 16	63	35	27	62	700	500	28	10
580-20	M 20	72	40	30	71	1200	830	45	5
580-24	M 24	90	50	36	90	1800	1270	74	
580-30	M 30	108	60	45	109	3600	2600	166	
580-36	M 36	126	70	54	128	5100	3700	265	
580-42	M 42	144	80	63	147	7000	5000	403	

TYPE 582



Oogmoeren
Ringmuttern
Eye-nuts

Anneaux de levage, femelle

E = Verzinkt/verzinkt/galvanized/zingué

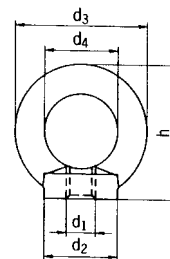
B = Blank/blank/polished/poli





 Art.no.	d1	d3 mm	d4 mm	h mm	WLL kg		Gewicht Gewicht Weight Poids kg/100	St./Pcs.
								
582-06	M 6	36	20	31	-	-	3	25
582-08	M 8	36	20	36	140	95	5	25
582-10	M 10	45	25	45	230	170	9	25
582-12	M 12	54	30	53	340	240	16	25
582-14	M 14	63	35	62	-	-	20	10
582-16	M 16	63	35	62	700	500	24	10
582-20	M 20	72	40	71	1200	830	36	5
582-24	M 24	90	50	90	1800	1270	72	
582-30	M 30	108	60	109	3600	2600	132	
582-36	M 36	126	70	128	5100	3700	208	
582-42	M 42	144	80	147	7000	5000	311	

6

Afsleephaken
Abschlepphaken
Eye-hooks
Crochets de traine

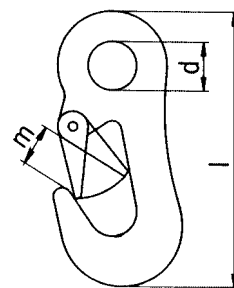
Verzinkt/verzinkt/galvanized/zingué



 Art.no.	Oog Öse Eye Œil d ø mm	l mm	M mm	Gewicht Gewicht Weight Poids kg/100	St./Pcs.
	695-18E	18	90	9	12

09.2005

